

# PRIME MINI

PRODUCT INFORMATION GUIDE

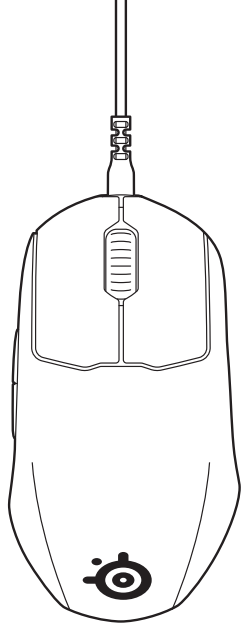

# CONTENTS

Welcome	2	<b>Translations</b>	
SteelSeries Engine	3	Español	9
Product Overview	5–6	简体中文	10
Setup	7	繁體中文	11
CPI Button Functions	8	日本語	12
		한국어	13
		Deutsch	14
		Русский	15
		Français	17
		Italiano	19
		Português	20
		Polskie	21
		<b>Regulatory</b>	<b>23</b>

# PRIMED FOR VICTORY

Your new mouse is the result of our unyielding pursuit of perfection for over 20 years. We poured our hearts into creating the best possible gaming mouse by pushing the boundaries of performance through precision, comfort, and durability. The Prime Mini is our glory, now go chase yours.

# STEELSERIES ENGINE

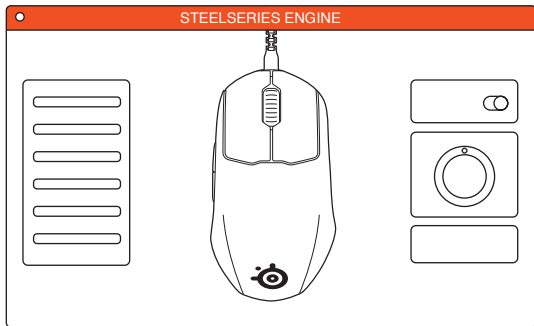

To enjoy **GameSense Integration**, custom lighting effects, customization of mouse settings, as well as programming macros on your new Prime Mini mouse, download SteelSeries Engine at [steelseries.com/engine](https://steelseries.com/engine)

## PACKAGE CONTENTS

Prime Mini Mouse

USB Type-C to USB Type-A Cable  
(6'10" / 2.08 m)

Product Information Guide

## SYSTEM REQUIREMENTS // COMPATIBILITY

PC

Mac

Xbox

## STEELSERIES ENGINE SOFTWARE REQUIREMENTS

Platforms

Windows 7+

Mac OS X 10.13+

140 MB of free hard drive space for  
installation

## PRODUCT OVERVIEW

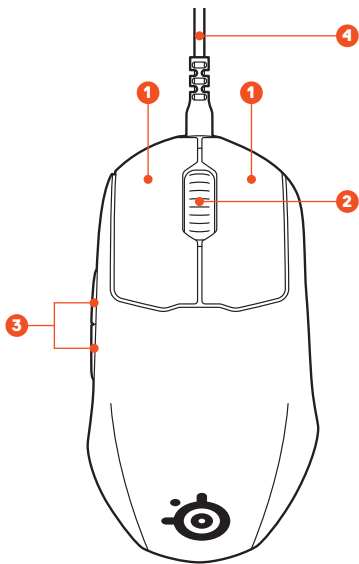

- 1 Split Trigger Design  
Main Mouse Buttons
- 2 Scroll Wheel
- 3 Side Buttons
- 4 USB Type-C to USB Type-A  
Super Mesh Data/Charging  
Cable
- 5 Virgin Grade PTFE Mouse Feet
- 6 CPI Button
- 7 TrueMove Pro Sensor

find accessories and replacement parts at [steelseries.com/gaming-accessories](https://steelseries.com/gaming-accessories)

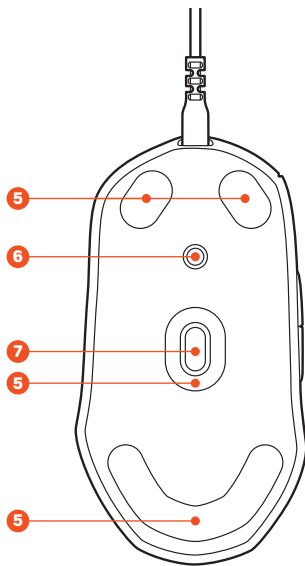

# SETUP

find help at [support.steelseries.com](https://support.steelseries.com)

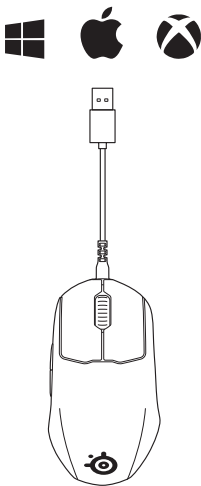



# CPI BUTTON FUNCTIONS

## CPI VALUE

Quick press the CPI Button **8** to change the CPI level. A solid color will appear on the Scroll Wheel **2** for three seconds to signify the CPI level.

Level 1	400CPI	Purple
Level 2	800CPI	Blue
Level 3	1200CPI	Green
Level 4	2400CPI	Yellow
Level 5	3200CPI	Red

## POLLING RATE

Long press the CPI Button **8** to change the polling rate once. A flashing color will appear on the Scroll Wheel **2** for three seconds to signify the polling rate level. Long press again to cycle through polling rates.

Level 1	1000 Hz	Red
Level 2	500 Hz	Yellow
Level 3	250 Hz	Green
Level 4	125 Hz	Blue

## FACTORY RESET

Press and hold the CPI Button **8** and both Mouse Buttons **1** together for five seconds.

The Scroll Wheel **2** will flash pink three times before all settings will be reset to the factory settings.

# ESPAÑOL

## CONTENIDO DEL PAQUETE

Ratón Prime Mini

Cable USB tipo C a USB tipo A  
(6"10" / 2,08 m)

Guía de información del producto

## REQUISITOS DEL SISTEMA// COMPATIBILIDAD

PC / Mac / Xbox

## REQUISITOS DEL SOFTWARE STEELSERIES ENGINE

Plataformas

Windows 7 o superior

Mac OS X 10.13 o superior

140 MB de espacio libre en el disco duro para la instalación

## DESCRIPCIÓN GENERAL DEL PRODUCTO

- 1 Diseño de activador dividido Botones de ratón principales
- 2 Rueda de desplazamiento
- 3 Botones laterales
- 4 Cable de carga/datos Super Mesh USB tipo C a USB tipo A
- 5 Pies de ratón de Virgin Grade PTFE

6 Botón CPI

7 Sensor TrueMove Pro  
Consulta accesorios y repuestos en  
[steelseries.com/gaming-accessories](https://steelseries.com/gaming-accessories)

## CONFIGURACIÓN

Si necesitas ayuda, visita [support.steelseries.com](https://support.steelseries.com)

## FUNCIONES DEL BOTÓN CPI

### VALOR DE CPI

Pulsa rápidamente el botón CPI **6** para cambiar el nivel de CPI. Se mostrará un color sin parpadear durante tres segundos en la rueda de desplazamiento **2** para indicar el nivel de CPI.

Nivel 1	CPI 400	Morado
Nivel 2	CPI 800	Azul
Nivel 3	CPI 1200	Verde
Nivel 4	CPI 2400	Amarillo
Nivel 5	CPI 3200	Rojo

### TASA DE SONDEO

Mantén pulsado el botón CPI **6** para cambiar una vez la tasa de sondeo. Parpadeará un color durante tres segundos en la rueda de desplazamiento **2** para indicar el nivel de tasa de sondeo.

Mantenlo presionado otra vez para moverte

por las tasas de sondeo.

Nivel 1	1000 Hz	Rojo
Nivel 2	500 Hz	Amarillo
Nivel 3	250 Hz	Verde
Nivel 4	125 Hz	Azul

## 简体中文

### 包装内容

Prime Mini 鼠标

USB Type-C 到 USB Type-A 电缆  
(6' 10" / 2.08m)

产品信息指南

### 系统要求 // 兼容性

PC / Mac / Xbox

### STEELSERIES ENGINE 软件要求

平台

Windows 7+

Mac OS X 10.13+

140MB 硬盘空间

### 产品概览

- 1 分离式设计按键
- 2 滚轮

### RESTABLECIMIENTO DE FÁBRICA

Mantén pulsado el botón CPI **6** y ambos botones del ratón **1** al mismo tiempo durante cinco segundos. La rueda de desplazamiento **2** parpadeará en rosa tres veces antes de que todos los ajustes se restablezcan a los valores de fábrica.

- 3 侧键
- 4 USB Type-C 到 USB Type-A 超级网格数据/充电线
- 5 Virgin Grade PTFE 鼠脚
- 6 CPI 按钮
- 7 TrueMove Pro 传感器

如需查找配件和更换零件, 请访问  
[steelseries.com/gaming-accessories](https://steelseries.com/gaming-accessories)

### 设置

如需帮助, 请访问 [support.steelseries.com](https://support.steelseries.com)

### CPI 按钮功能

#### CPI 值

快速按下 CPI 按钮 **6**, 变换 CPI 等级。滚轮 **2** 显示彩灯常亮三秒钟, 表示 CPI 等级。

1 级	400 CPI	紫色
2 级	800 CPI	蓝色

3 级	1200 CPI	绿色	2 级	500 Hz	黄色
4 级	2400 CPI	黄色	3 级	250 Hz	绿色
5 级	3200 CPI	红色	4 级	125 Hz	蓝色

### 巡检速度

长按 CPI 按钮 **6**，单次变换巡检速度。滚轮 **2** 显示彩灯闪烁三秒钟，表示巡检速度。再次长按循环巡检速度。

1 级	1000 Hz	红色
-----	---------	----

### 恢复出厂设置

同时按住 CPI 按钮 **6** 和鼠标按钮 **1** 五秒钟。滚轮 **2** 将闪烁粉色灯三次，之后所有设置都将恢复出厂设置。

## 繁體中文

### 包裝內容

Prime Mini 滑鼠

USB Type-C 轉 USB Type-A 連接線  
(6 呎 10 吋 / 2.08 米)

產品資訊指南

### 系統要求//相容性

PC / Mac / Xbox

### STEELSERIES ENGINE 軟件要求

平台

Windows 7+

Mac OS X 10.13+

安裝時需要有 140 MB 可用的硬碟空間

### 產品概述

- 1 分離式設計按鍵
  - 2 滾輪
  - 3 側鍵
  - 4 USB Type-C 轉 USB Type-A 卓越編織數據線 / 充電線
  - 5 Virgin Grade PTFE 滑鼠腳墊
  - 6 CPI 按鍵
  - 7 TrueMove Pro 感應器
- 如需配件或替換零件，請瀏覽 [steelseries.com/gaming-accessories](https://steelseries.com/gaming-accessories)

### 設定

如需協助，請前往 [support.steelseries.com](https://support.steelseries.com)

### CPI 按鍵功能

CPI 數值

速按 CPI 按鍵 **6** 以更改 CPI 級別。滾輪 **2** 上將顯示一種純顏色長達三秒鐘，以代表其 CPI 級別

1 級	400 CPI	紫色
2 級	800 CPI	藍色
3 級	1200 CPI	綠色
4 級	2400 CPI	黃色
5 級	3200 CPI	紅色

### 回報率

長按 CPI 按鍵 **6** 以更改回報率一次。滾輪 **2** 上將顯示一種閃爍的顏色長達三秒鐘，以代表其回

報率級別。再次長按以循環查看回報率。

1 級	1000 Hz	紅色
2 級	500 Hz	黃色
3 級	250 Hz	綠色
4 級	125 Hz	藍色

### 恢復出廠設定

同時按住 CPI 按鍵 **6** 和兩個滑鼠按鍵 **1** 長達 5 秒鐘。在所有設定重設為出廠設定之前，滾輪 **2** 將以粉紅色閃爍三次。

## 日本語

### パッケージ内容

Prime Miniマウス

USB Type-C~USB Type-A ケーブル  
(6' 10" / 2.08 m)

製品情報ガイド

### システム要件//互換性

PC / Mac / Xbox

### STEELSERIES ENGINEソフトウェア要件

プラットフォーム

Windows 7以降

Mac OS X 10.13以降

インストール用のハードドライブ空き容量140MB

### 製品概要

- 1 スプリットトリガーデザイン メインマウスボタン
- 2 スクロールホイール
- 3 サイドボタン
- 4 USB Type-C → USB Type-A スーパーメッシュデュータ/充電ケーブル
- 5 Virgin Grade PTFEマウスフィート
- 6 CPIボタン
- 7 TrueMove Proセンサー  
アクセサリおよび交換部品について

は、[steelseries.com/gaming-accessories](https://steelseries.com/gaming-accessories)をご覧ください

### セットアップ

ヘルプについては、[support.steelseries.com](https://support.steelseries.com)をご覧ください

### CPIボタン機能

#### CPI値

CPIレベルを変更するには、CPIボタン⑥を早押しします。スクロールホイール②は3秒間点灯する単色で、CPIレベルを示します。

Level 1	400 CPI	紫色
Level 2	800 CPI	青色
Level 3	1200 CPI	緑色
Level 4	2400 CPI	黄色
Level 5	3200 CPI	赤色

### 4ポーリングレート

ポーリングレートを1回変更するには、CPIボタン⑥を長押しします。スクロールホイール②は3秒間点滅する色で、ポーリングレートレベルを示します。

## 한국어

### 패키지 구성품

Prime Mini 마우스

USB-C to USB-A 케이블 (6'10"/2.08m)

再度長押しして、ポーリングレートを繰り返し表示します。

Level 1	1000 Hz	赤色
Level 2	500 Hz	黄色
Level 3	250 Hz	緑色
Level 4	125 Hz	青色

### 팩토리리셋

CPIボタン⑥と両方のマウスボタン①を5秒間一緒に押し続けます。

すべての設定が工場出荷時の設定にリセットされる前に、スクロールホイール②はピンク色で3回点滅します。

제품 정보 안내

시스템 요구 사항 // 호환성

PC / Mac / Xbox

## STEELSERIES ENGINE 소프트웨어 요구 사항 플랫폼

Windows 7 이상

Mac OS X 10.13 이상

설치를 위한 140MB의 하드 드라이브 여유 공간

### 제품 개요

- 1 분할 트리거 디자인 기본 마우스 버튼
- 2 스크롤 휠
- 3 사이드 버튼
- 4 USB-C to USB-A 슈퍼 메시 데이터/충전 케이블
- 5 Virgin Grade PTFE 마우스 피트
- 6 CPI 버튼
- 7 TrueMove Pro 센서

액세서리 및 교체 부품 찾아보기:

[steelseries.com/gaming-accessories](https://steelseries.com/gaming-accessories)

### 설정

도움말 보기: [support.steelseries.com](https://support.steelseries.com)

### CPI 버튼 기능

#### CPI 값

CPI 버튼 **6**을 빠르게 누르면 CPI 레벨이 변경됩니다. 이어 CPI 레벨을 나타내는 색이 스크롤 휠 **2**에 3초 동안 표시됩니다.

레벨 1      400 CPI      보라색

레벨 2      800 CPI      파란색

레벨 3      1200 CPI      녹색

레벨 4      2400 CPI      노란색

레벨 5      3200 CPI      빨간색

### 폴링 레이트

CPI 버튼 **6**을 길게 누르면 폴링 레이트가 한 차례 변경됩니다. 이어 폴링 레이트 레벨을 나타내는 색이 스크롤 휠 **2**에 3초 동안 점멸합니다.

다시 길게 누르면 폴링 레이트가 순환됩니다.

레벨 1      1000 Hz      빨간색

레벨 2      500 Hz      노란색

레벨 3      250 Hz      녹색

레벨 4      125 Hz      파란색

### 공장 초기화

CPI 버튼 **6**과 양쪽 마우스 버튼 **1**을 함께 5초 동안 길게 누릅니다.

이어 스크롤 휠 **2**이 핑크색으로 세 번 점멸하고 모든 설정이 공장 설정으로 초기화됩니다.

# DEUTSCH

## LIEFERUMFANG

Prime Mini Maus

USB Typ-C auf USB Typ-A-Kabel  
(6'10"/2,08 m)

Produktinformationshandbuch

## SYSTEMANFORDERUNGEN // KOMPATIBILITÄT

PC / Mac / Xbox

## STEELSERIES ENGINE – SOFTWAREANFORDERUNGEN

Plattformen

Windows 7 und neuer

Mac OS X 10.13 und neuer

140 MB freier Festplattenspeicher für die  
Installation

## PRODUKTÜBERSICHT

- 1 Split-Trigger-Design Haupt-Maustasten
- 2 Scroll-Rad
- 3 Seitentasten
- 4 USB Typ-C zu USB Typ-A Super-Mesh-Daten-/Ladekabel
- 5 Virgin Grade PTFE Mausfüße
- 6 CPI-Taste

7 Sensor TrueMove Pro

Zubehör- und Ersatzteile auf  
[steelseries.com/gaming-accessories](https://steelseries.com/gaming-accessories)

## INSTALLATION

Du brauchst Hilfe? [support.steelseries.com](https://support.steelseries.com)

## FUNKTIONEN DER CPI-TASTE

### CPI-WERT

Drücke kurz auf die CPI-Taste **6**, um den CPI-Wert zu verändern. Auf dem Scroll-Rad **2** leuchtet 3 Sekunden lang eine Farbe, die den CPI-Wert anzeigt.

Wert 1	400 CPI	Lila
Wert 2	800 CPI	Blau
Wert 3	1200 CPI	Grün
Wert 4	2400 CPI	Gelb
Wert 5	3200 CPI	Rot

### ABFRAGERATE

Drücke längere Zeit auf die CPI-Taste **6**, um die Abfragerate zu verändern. Auf dem Scroll-Rad **2** blinkt 3 Sekunden lang eine Farbe, die den Wert der Abfragerate anzeigt.

Drücke erneut längere Zeit auf die Taste, um durch die Werte zu wechseln.

Wert 1	1000 Hz	Rot
--------	---------	-----



Wert 2	500 Hz	Gelb
Wert 3	250 Hz	Grün
Wert 4	125 Hz	Blau

## ZURÜCKSETZEN AUF DIE WERKSEINSTELLUNGEN

Halte die CPI-Taste **6** und die beiden Maustasten **1** zusammen 5 Sekunden lang gedrückt.

Das Scroll-Rad **2** blinkt dreimal pink, bevor alle Einstellungen auf die Werkseinstellungen zurückgesetzt werden.

## РУССКИЙ

### КОМПЛЕКТАЦИЯ

Мышь Prime Mini

Кабель USB Type-C - USB Type-A (6 футов / 10 дюймов / 2,08 м)

Информационное руководство по продукту

### СИСТЕМНЫЕ ТРЕБОВАНИЯ/ СОВМЕСТИМОСТЬ

PC / Mac / Xbox

### ТРЕБОВАНИЯ ПРОГРАММНОГО ПАКЕТА STEELSERIES ENGINE

Платформы

Windows 7 и более поздние

Mac OS X 10.13 и более поздние

140 Мбайт свободного места на жестком диске для установки

### КРАТКИЕ СВЕДЕНИЯ О ПРОДУКТЕ

- 1 Конструкция типа Split Trigger  
Основные кнопки мыши
- 2 Колесо прокрутки
- 3 Боковые кнопки
- 4 Кабель Super Mesh USB Type-C — USB Type-A для зарядки/передачи данных
- 5 Фторопластовые опорные накладки
- 6 Кнопка CPI
- 7 Датчик TrueMove Pro

Для подбора аксессуаров и запасных частей перейдите на страницу [steelseries.com/gaming-accessories](https://steelseries.com/gaming-accessories)

### НАСТРОЙКА

Справочную информацию см. на сайте [support.steelseries.com](https://support.steelseries.com)

### ФУНКЦИИ КНОПКИ CPI ЗНАЧЕНИЕ CPI

Быстро нажмите кнопку CPI **6**, чтобы изменить уровень CPI. Колесо прокрутки **2** в течение трех секунд будет окрашено в определенный цвет, указывающий на уровень CPI

Уровень 1	400 CPI	фиолетовый
Уровень 2	800 CPI	синий
Уровень 3	1200 CPI	зеленый
Уровень 4	2400 CPI	желтый
Уровень 5	3200 CPI	красный

### ЧАСТОТА ОПРОСА

Однократное изменение частоты опроса выполняется длительным нажатием на кнопку CPI **6**. Колесо прокрутки **2** в течение трех секунд будет мигать определенным цветом, указывающим на уровень частоты опроса.

## FRANÇAIS

### CONTENU DE L'EMBALLAGE

Souris Prime Mini

Câble USB de type-C vers USB de type-A (6'10" / 2,08 m)

Guide d'informations sur le produit

### CONFIGURATION SYSTÈME REQUISE //

Повторное длительное нажатие позволит последовательно переключать значение частоты опроса.

Уровень 1	1000 Гц	красный
Уровень 2	500 Гц	желтый
Уровень 3	250 Гц	зеленый
Уровень 4	125 Гц	синий

### ВОЗВРАТ К ЗАВОДСКИМ НАСТРОЙКАМ

Одновременно нажмите и удерживайте в течение пяти секунд кнопку CPI **6** и обе кнопки мыши **1**.

Колесо прокрутки **2** трижды мигнет розовым цветом перед тем, как все настройки будут возвращены к заводским значениям.

### COMPATIBILITÉ

PC / Mac / Xbox

### EXIGENCES DU LOGICIEL STEELSERIES ENGINE

Plateformes

Windows +

Mac OS X 10.13 +

140 Mo d'espace disque dur libre pour l'installation

## VUE D'ENSEMBLE DU PRODUIT

- 1 Conception à gâchette scindée principaux boutons de la souris
- 2 Molette de défilement
- 3 Boutons latéraux
- 4 Câble de chargement/données Super Mesh USB Type-C vers USB Type-A
- 5 Pieds de souris en Virgin Grade PTFE
- 6 Bouton CPI
- 7 Capteur TrueMove Pro

Retrouvez des accessoires et des pièces de rechange sur [steelseries.com/gaming-accessories](https://steelseries.com/gaming-accessories)

## CONFIGURATION

Obtenez de l'aide sur [support.steelseries.com](https://support.steelseries.com)

## FONCTIONS DU BOUTON CPI

### VALEUR CPI

Appuyez brièvement sur le bouton CPI **6** pour modifier le niveau de CPI. Une couleur fixe apparaît sur la molette de défilement **2** pendant trois secondes pour indiquer le niveau de CPI

Niveau 1	400 CPI	Mauve
----------	---------	-------

Niveau 2	800 CPI	Bleu
Niveau 3	1200 CPI	Vert
Niveau 4	2400 CPI	Jaune
Niveau 5	3200 CPI	Rouge

## VITESSE D'INTERROGATION

Appuyez longuement sur le bouton CPI **6** pour modifier la vitesse d'interrogation une fois. Une couleur clignotante apparaît sur la molette de défilement **2** pendant trois secondes pour indiquer le niveau de vitesse d'interrogation.

Appuyez à nouveau longuement pour parcourir les vitesses d'interrogation.

Niveau 1	1000 Hz	Rouge
Niveau 2	500 Hz	Jaune
Niveau 3	250 Hz	Vert
Niveau 4	125 Hz	Bleu

## RÉTABLISSEMENT DES PARAMÈTRES D'USINE

Appuyez sur le bouton CPI **6** et les deux boutons de la souris **1** simultanément et maintenez-les enfoncés pendant cinq secondes.

La molette de défilement **2** clignote en rose trois fois avant le rétablissement de tous les paramètres d'usine.

# ITALIANO

## CONTENUTO DELLA CONFEZIONE

Mouse Prime Mini

Cavo da USB di tipo C a USB di tipo A  
(2,08 m/6'10")

Guida informazioni sul prodotto

## REQUISITI DI SISTEMA // COMPATIBILITÀ

PC / Mac / Xbox

## REQUISITI SOFTWARE STEELSERIES ENGINE

Piattaforme

Windows 7 e versioni successive

Mac OS X 10.13 e versioni successive

140 MB di spazio libero sul disco rigido per  
l'installazione

## PANORAMICA DEL PRODOTTO

- 1 Design trigger separato pulsanti principali del mouse
- 2 Rotellina di scorrimento
- 3 Pulsanti laterali
- 4 Cavo di ricarica/dati super mesh da USB di tipo C a USB di tipo A
- 5 Piedini per mouse in Virgin Grade PTFE

6 Pulsante CPI

7 Sensore TrueMove Pro

\* Accessori e parti di ricambio sono disponibili sul sito [steelseries.com/gaming-accessories](https://steelseries.com/gaming-accessories)

## CONFIGURAZIONE

per assistenza, visitare [support.steelseries.com](https://support.steelseries.com)

## FUNZIONI PULSANTE CPI

### VALORE CPI

Premere rapidamente il pulsante CPI **6**] per modificare il livello CPI. Un colore a tinta unita apparirà sulla rotellina di scorrimento **2** per tre secondi per indicare il livello CPI

Livello 1	400 CPI	Viola
Livello 2	800 CPI	Blu
Livello 3	1200 CPI	Verde
Livello 4	2400 CPI	Giallo
Livello 5	3200 CPI	Rosso

## FREQUENZA DI POLLING

Premere a lungo il pulsante CPI **6** per modificare il tasso di polling una sola volta. Un colore lampeggiante apparirà sulla rotellina di scorrimento **2** per tre secondi per indicare il livello di frequenza di polling.

Premere di nuovo a lungo per scorrere i tassi di polling.

Livello 1	1000 Hz	Rosso
Livello 2	500 Hz	Giallo
Livello 3	250 Hz	Verde
Livello 4	125 Hz	Blu

## PORTUGUÊS

### CONTEÚDO DA EMBALAGEM

Rato Prime Mini

Cabo USB tipo C para USB tipo A  
(6"10"/2,08m)

Guia de Informações sobre o produto

### REQUISITOS DO SISTEMA// COMPATIBILIDADE

PC / Mac / Xbox

### REQUISITOS DO SOFTWARE STEELSERIES ENGINE

Plataformas

Windows 7 +

Mac OS X 10.13 +

Disco rígido de 140MB de espaço livre para instalação

### RIPRISTINO DI FABBRICA

Tenere premuto il pulsante CPI **6** ed entrambi i pulsanti del mouse **1** insieme per cinque secondi.

La rotella di scorrimento **2** lampeggia in rosa tre volte prima che tutte le impostazioni vengano ripristinate alle impostazioni di fabbrica.

### VISÃO GERAL DO PRODUTO

- 1 Design de botão acionador dividido botões principais do rato
- 2 Roda do rato
- 3 Botões laterais
- 4 Cabo de dados/carregamento Super Mesh USB Tipo C para USB Tipo A
- 5 Pés do rato em Virgin Grade PTFE
- 6 Botão CPI
- 7 Sensor TrueMove Pro

Encontre acessórios e peças de substituição em [steelseries.com/gaming-accessories](https://steelseries.com/gaming-accessories)

### CONFIGURAÇÃO

Obtenha ajuda em [support.steelseries.com](https://support.steelseries.com)

### FUNÇÕES DO BOTÃO CPI

## VALOR CPI

Pressione rapidamente o botão CPI **6** para alterar o nível de CPI. Uma cor sólida irá aparecer na roda do rato **2** durante três segundos para indicar o nível CPI

Nível 1	400 CPI	Roxo
Nível 2	800 CPI	Azul
Nível 3	1200 CPI	Verde
Nível 4	2400 CPI	Amarelo
Nível 5	3200 CPI	Vermelho

## TAXA DE CONSULTA

Pressione durante algum tempo o botão CPI **6** para alterar a taxa de consulta uma vez. Uma cor intermitente irá aparecer na roda do rato **2** durante três segundos para indicar o

nível da taxa de consulta.

Pressione durante algum tempo para percorrer as taxas de consulta.

Nível 1	1000 Hz	Vermelho
Nível 2	500 Hz	Amarelo
Nível 3	250 Hz	Verde
Nível 4	125 Hz	Azul

## REPOSIÇÃO DE FÁBRICA

Pressione e segure o botão CPI **6** e ambos os botões do rato **1** em conjunto durante cinco segundos.

A roda do rato **2** irá piscar a cor-de-rosa três vezes antes que todas as configurações sejam repostas para as configurações de fábrica.

## POLSKIE

### ZAWARTOŚĆ OPAKOWANIA

Mysz Prime Mini

Kabel USB typu C do USB typu A  
(2,08 m/6'10")

Przewodnik po produkcji

WYMAGANIA SYSTEMOWE //

### KOMPATYBILNOŚĆ

PC / Mac / Xbox

### WYMAGANIA DOTYCZĄCE OPROGRAMOWANIA SILNIKA SERII STEELSERIES

Platformy

Windows 7+

Mac OS X 10.13+

140 MB wolnego miejsca na dysku do instalacji

## PRZEGLĄD PRODUKTU

- 1 Rozdzielone główne przyciski myszy
- 2 Kółko przewijania
- 3 Przyciski boczne
- 4 Kabel USB typu-C do USB typu-A super Mesh do transmisji danych/ladowania
- 5 Stopy myszy z Virgin Grade PTFE
- 6 Przycisk CPI
- 7 Czujnik TrueMove Pro

Akcesoria i części zamienne znajdziesz na stronie [steelseries.com/gaming-accessories](http://steelseries.com/gaming-accessories)

## KONFIGURACJA

Pomoc znajdziesz w witrynie [support.steelseries.com](http://support.steelseries.com)

## FUNKCJE PRZYCISSKU CPI

### WARTOŚĆ CPI

Naciśnij i przytrzymaj przycisk CPI **6**, aby raz zmienić częstotliwość raportowania. Na kółku przewijania **2** przez trzy sekundy pojawi się migający kolor, oznaczający poziom CPI.

Poziom 1  
fioletowy      CPI 400

Poziom 2      CPI 800

niebieski

Poziom 3  
zielony      CPI 1200

Poziom 4      CPI 2400      żółty

Poziom 5  
czerwony      CPI 3200

## CZĘSTOTLIWOŚĆ RAPORTOWANIA

Naciśnij i przytrzymaj przycisk CPI **6**, aby raz zmienić częstotliwość raportowania. Na kółku przewijania **2** przez trzy sekundy pojawi się migający kolor, oznaczający poziom CPI.

Naciśnij i przytrzymaj przycisk ponownie, aby kolejno przejść przez poziomy częstotliwości raportowania.

Poziom 1  
czerwony      1000 Hz

Poziom 2      500 Hz      żółty

Poziom 3  
zielony      250 Hz

Poziom 4  
niebieski      125 Hz

## PRZYWRACANIE USTAWIEŃ FABRYCZNYCH

Naciśnij i przytrzymaj przez pięć sekund jednocześnie przycisk CPI **6** i obydwa przyciski myszy **1**.

Kółko przewijania **2** zamiga trzy razy na różowo, zanim wszystkie ustawienia zostaną zresetowane do ustawień fabrycznych.

# REGULATORY



## Europe – EU Declaration of Conformity

Hereby, SteelSeries ApS. declares that the equipment which is compliance with directive RoHS 2.0 (2015/863/EU), EMC Directive (2014/30/EU), and LVD (2014/35/EU) which are issued by the Commission of the European Community.

The full text of the EU declaration of conformity is available at the following internet address: <https://steelseries.com/>

Operating Temperature: 0 to + 40 °C

SteelSeries ApS. hereby confirms, to date, based on the feedback from our suppliers indicates that our products shipping to the EU territory comply with REACH (Registration, Evaluation, Authorization, and Restriction of Chemicals - (EC) 1907/2006) compliance program. We are fully committed to offering REACH compliance on the products and posting accurate REACH compliance status for the all of products.



## WEEE

This product must not be disposed of with your other household waste or treat them in compliance with the local regulations or contact your local city office, your household waste disposal service or the shop where you purchased the product.

Türkiye Cumhuriyeti: EEE Yönetmeliğine Uygundur

## Ukraine RoHS:

Обладнання відповідає вимогам Технічного регламенту щодо обмеження використання деяких небезпечних речовин в електричному та електронному обладнанні, затвердженого постановою Кабінету Міністрів України від 3 грудня 2008 № 1057

This product is compliant with requirements of Vietnam Circular No. 30/2011/TT-BCT Regulations "STIPULATING TEMPORARILY THE PERMISSIBLE CONTENT LIMITATION OF SOME TOXIC CHEMICALS IN THE ELECTRONIC, ELECTRICAL PRODUCTS"



### **Restriction on Hazardous Substances statement (India)**

This product complies with the "India E-waste Rule 2011" and prohibits use of lead, mercury, hexavalent chromium, polybrominated biphenyls or polybrominated diphenyl ethers in concentrations exceeding 0.1 weight % and 0.01 weight % for cadmium, except for the exemptions set in Schedule 2 of the Rule.

### **《废弃电器电子产品回收处理管理条例》提示性说明**

为了更好地关爱及保护地球,当用户不再需要此产品或产品寿命终止时,请遵守国家废弃电器电子产品回收处理相关法律法规,将其交给当地具有国家认可的回收处理资质的厂商进行回收处理。



### **Federal Communication Commission Interference Statement**

This device complies with Part 15 of the FCC Rules. Operation is subject to the following two conditions: (1) This device may not cause harmful interference, and (2) this device must accept any interference received, including interference that may cause undesired operation.

This equipment has been tested and found to comply with the limits for a Class B digital device, pursuant to Part 15 of the FCC Rules. These limits are designed to provide reasonable protection against harmful interference in a residential installation. This equipment generates, uses and can radiate radio frequency energy and, if not installed and used in accordance with the instructions, may cause harmful interference to radio communications. However, there is no guarantee that interference will not occur in a particular installation. If this equipment does cause harmful interference to radio or television reception, which can be determined by turning the equipment off and on, the user is encouraged to try to correct the interference by one of the following measures:

Reorient or relocate the receiving antenna.

Increase the separation between the equipment and receiver.

Connect the equipment into an outlet on a circuit different from that to which the receiver is connected.

Consult the dealer or an experienced radio/TV technician for help.

### **Industry Canada Statement:**

This device complies with RSS standards of the Industry Canada Rules. Operation is subject to

the following two conditions: (1) This device may not cause harmful interference, and (2) this device must accept any interference received, including interference that may cause undesired operation.

Ce dispositif est conforme à la norme CNR d'Industrie Canada applicable aux appareils radio exempts de licence. Son fonctionnement est sujet aux deux conditions suivantes: (1) le dispositif ne doit pas produire de brouillage préjudiciable, et (2) ce dispositif doit accepter tout brouillage reçu, y compris un brouillage susceptible de provoquer un fonctionnement indésirable.

This Class B digital apparatus complies with Canadian ICES-003.

Cet appareil numérique de la classe B est conforme à la norme NMB-003 du Canada.

### **SteelSeries Products and Australian Consumer Law**

Our goods come with guarantees that cannot be excluded under Australian consumer law. You are entitled to a repair, replacement, or refund for a major failure and compensation for any other reasonably foreseeable loss or damage. You are also entitled to have the goods repaired or replaced if the goods fail to be of acceptable quality and the failure does not amount to a major failure.

Should your product be defective, you can make a claim under Australian consumer law.

SteelSeries will provide its own remedies equivalent to those remedies in the consumer guarantee provisions of the Australian Consumer Law at any time within 24 months of the date of purchase. For the avoidance of doubt, SteelSeries acknowledges that the Australian Consumer Law may provide for remedies beyond 24 months for a number of its products.

### **Summary of Australian statutory consumer guarantees**

#### **Consumer guarantees in relation to goods**

The goods will be of acceptable quality, The goods will be fit for a particular purpose, The goods will match their description, The goods will match the sample or demonstration model, You have title to the goods, You have undisturbed possession of the goods, There are no undisclosed securities on the goods.

#### **Consumer guarantees in relation to services**

We will provide the services with due care and skill, The services will be fit for a particular purpose, The services will be provided within a reasonable time.

For SteelSeries-branded goods, in addition to the above, we also guarantee that we will provide repairs or spare parts for a reasonable time. Under Australian consumer law, the remedy you are

entitled to if a product fails to meet a consumer guarantee will depend on whether the failure to comply with the guarantee is major or minor.

Minor failures to comply with a consumer guarantee can normally be fixed or resolved in a reasonable amount of time. In this case, the seller can choose to offer you a refund, replacement, repair or, in the case of services, resupply. If the seller does not fix the problem or takes too long, you may be able to get it fixed by someone else and recover the costs from the seller depending on the circumstances.

#### **Remedies for major failure with goods**

Return the product and ask for a refund, Return the product and ask for an identical replacement, or one of similar value if reasonably available, Keep the product and ask for compensation for the drop in value caused by the problem.

#### **Remedies for major failure with services**

Cancel the contract and pay a reasonable amount for the work done, or seek a refund, For money already paid, keep the contract and negotiate a reduced price for the drop in value of the service — this may mean asking for some of your money back if you have already paid.

For goods, there is a major failure to comply with a consumer guarantee when:

- You would not have purchased the product if you had known about the problem.
- The product is significantly different from the description, sample or demonstration model you were shown.
- The product is substantially unfit for its normal purpose and cannot easily be made fit within a reasonable time.
- The product is substantially unfit for a purpose that you told the supplier about, and cannot easily be made fit within a reasonable time.
- The product is unsafe.

#### **For services, there is a major failure to comply with a consumer guarantee when:**

- You would not have engaged the service if you had known the nature and extent of the problem.
- The service does not meet the reasonable expectations for that type of service, and the problem cannot be rectified within a reasonable time.
- You told the supplier that you wanted the service for a specific purpose, which was not fulfilled, and the problem could not be easily rectified within a reasonable time.
- You told the supplier that you wanted a specific result, yet the service and end result failed to meet your specifications and could not be easily rectified within a reasonable time.

· The supply of the service has created an unsafe situation.

For information on Australian consumer laws, please visit Australian consumer law website at <http://www.consumerlaw.gov.au>.

**Importer Name and Address:** Ingram Micro Pty LTD / Level1, 61 Dunning Avenue, Rosebery NSW 2018

**Telephone technical support:** +61-2-9381-6000



この装置は、クラスB機器です。この装置は、住宅環境で使用することを目的としていますが、この装置がラジオやテレビジョン受信機に近接して使用されると、受信障害を引き起こすことがあります。取扱説明書に従って正しい取り扱いをして下さい。VCCI-B  
이 기기는 가정용(B급) 전자파적합기기로서 주로 가정에서 사용하는 것을 목적으로 하며, 모든 지역에서 사용할 수 있습니다



1. 상호명: SteelSeries ApS.
2. 기기명칭: Mouse
3. 모델명: M-00026
4. 인증번호:R-R-SS4-M-00026
5. 제조사/제조국: SteelSeries ApS./China

The RoHS test method is based on the standards JIS C 0950 and CNS 15663.

設備名稱：滑鼠 Equipment name: Mouse		型號(型式)：M-00026 Type designation: M-00026				
單元 / Unit	限用物質及其化學符號 Restricted substances and its chemical symbols					
	鉛 Lead (Pb)	汞 Mercury (Hg)	鎘 Cadmium (Cd)	六價鉻 Hexavalent chromium (Cr+6)	多溴聯苯 Polybrominated biphenyls (PBB)	多溴二苯醚 Polybrominated diphenyl ethers (PBDE)
塑膠部件 / Plastic	○	○	○	○	○	○
電路板及元件 / PCBA	-	○	○	○	○	○
線材 / Cables	-	○	○	○	○	○
金屬部件 / Metal	-	○	○	○	○	○
<p>備考1. “超出0.1 wt %”及“超出0.01 wt %”係指限用物質之百分比含量超出百分比含量基準值。 Note 1: “Exceeding 0.1 wt %” and “exceeding 0.01 wt %” indicate that the percentage content of the restricted substance exceeds the reference percentage value of presence condition.</p> <p>備考2. ○係指該項限用物質之百分比含量未超出百分比含量基準值。 Note 2: ○ indicates that the percentage content of the restricted substance does not exceed the percentage of reference value of presence.</p> <p>備考3. ×係指該項限用物質為排除項目。 Note 3: × indicates that the restricted substance corresponds to the exemption</p>						

根据中国大陆《电子电气产品有害物质限制使用标识要求》，  
以下部分列出了产品中可能包含的有害物质的名称和含量：

零部件名称	有害物质					
	铅 (Pb)	汞 (Hg)	镉 (Cd)	六价铬 (Cr(VI))	多溴联苯 (PBB)	多溴二苯醚 (PBDE)
电路板组件	×	○	○	○	○	○
其他线材	×	○	○	○	○	○

\*：电路板组件包括印刷电路板及其构成的零部件，如电阻、电容、集成电路、连接器等。

本表格依据SJ/T 11364的规定编制。

○：表示该有害物质在该部件所有均质材料中的含量均在 GB/T 26572规定的限量要求以下。

×：表示该有害物质至少在该部件的某一均质材料中的含量超出GB/T 26572规定的限量要求；

上表中打“X”的部件，应功能需要，部分有害物质含量超出GB/T 26572规定的限量要求，但是符合欧盟RoHS法规要求(属于豁免部分)。

Regions	Contact Information	
Asia 亞洲	SteelSeries ApS. Taiwan Branch 16F, No.150, Jian-Yi Rd., Chung-Ho Dist, New Taipei City, Taiwan, R.O.C.(235) 丹麥商賽睿有限公司台灣分公司 新北市中和區建一路150號16樓	+886 2 8226 3858
USA	656 W Randolph St, Suite 3E, Chicago, IL 60661, USA	+1 312 258 9467
Europe	Dirch Passers Allé 27, 5.Sal., 2000 Frederiksberg, Denmark	+45 702 500 75

More information and support at [steelseries.com](http://steelseries.com)

Product Name (產品名稱/产品名称): Mouse (滑鼠/鼠标)

Model No. (型號/型号): M-00026

Rated (規格/规格): 5V  200mA

Made in China 中國製造/ 中国制造



该电子电气产品含有某些有害物质，  
在环保使用期限内可以放心使用，超  
过环保使用期限之后则应该进入回  
收循环系统。



Custom Union Compliance.  
(Russia / Belarus / Kazakhstan)



ACMA Compliance (Australia/  
New-Zealand)



Direct Current



learn more at [steelseries.com](https://steelseries.com)